

Tbike

MANUAL DE INSTALACIÓN

1. Accessory List



Lock nut*2



Thick spacer*1



Spring washer*2



Thin spacer*6



Water resistant cap
for charging port*2



Lock washer*2

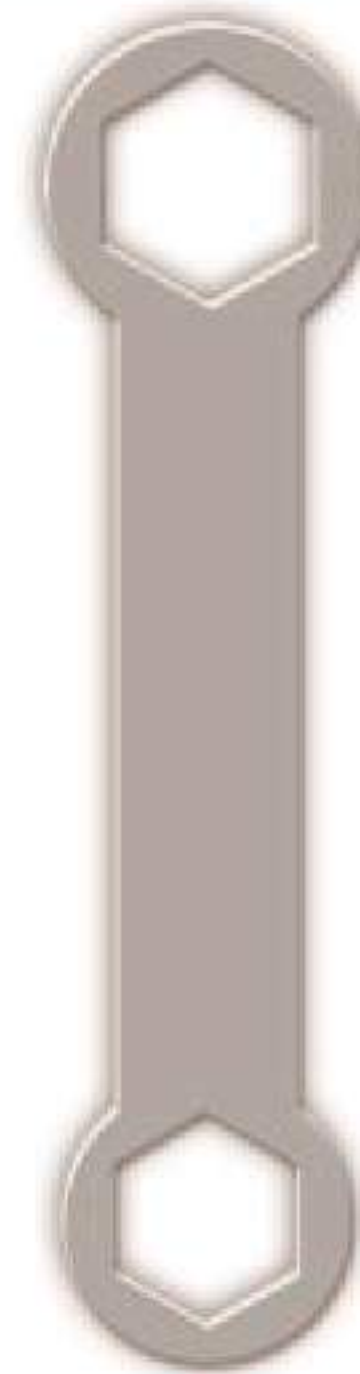

Wrench*1



Charger*1

*Slight changes of the accessories would not be further informed.

2. Checking when installation

01 Check the dimensions of the front fork

- Min fork width requirement:10 cm (± 0.1 cm)
- Min slot width of the forkends:1 cm (± 0.1 cm)



02 The end of the hub with leaves must be on the side as below:



The end with leaves of the hub must be on the right side of the bike. Don not install reversely

If you have disc brakes, the disc must be on the left side of the bike. If your bicycle is installed with leaves of the hub on the left side, it means that the handlebar and the front fork are installed reversely. Please turn the handlebar and front fork.

3. Checking when installation (Continued)

The notch on the axis must be positioned towards the handlebars, otherwise the motor will not work correctly.

This notch points to the handlebars



4. Installation Position

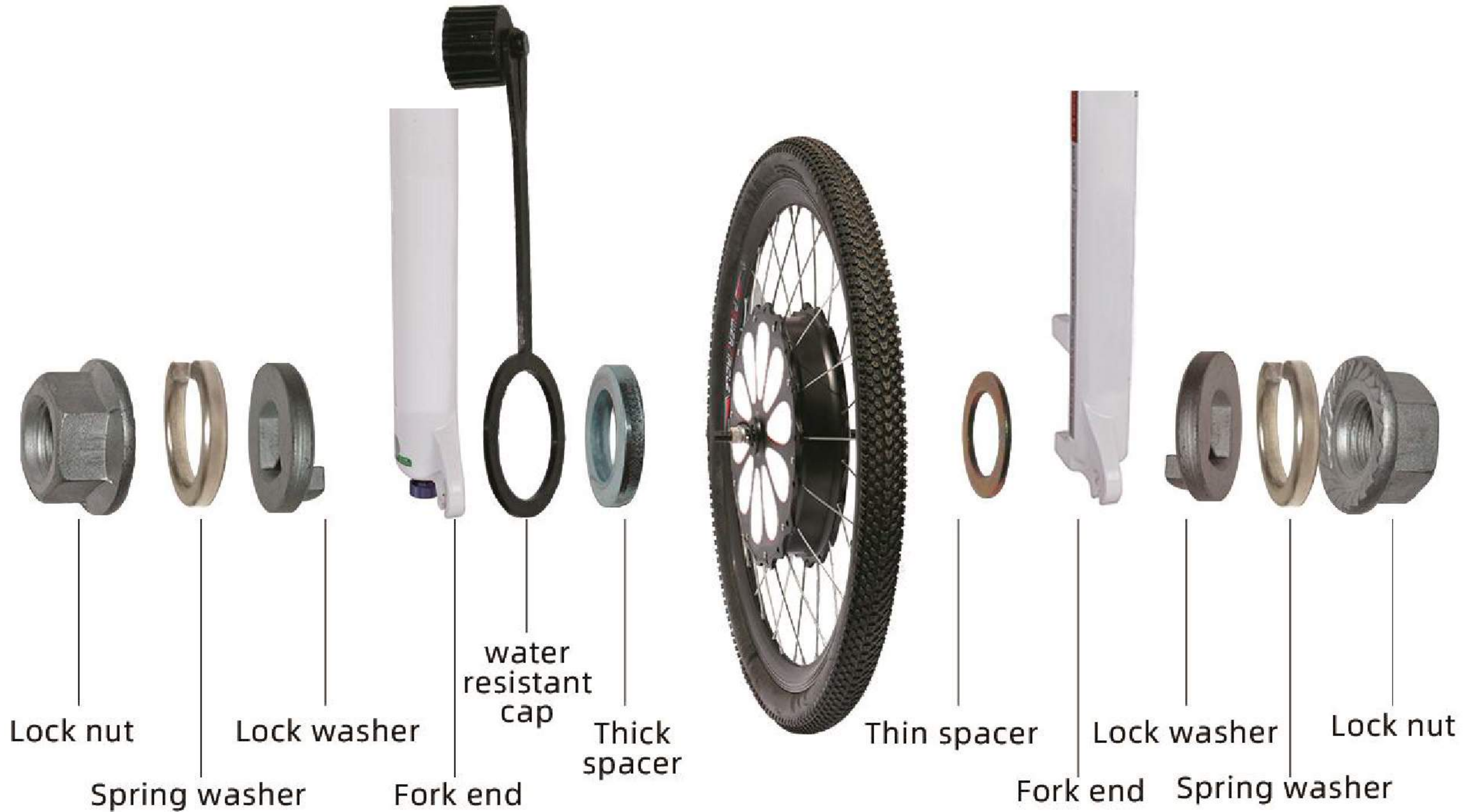

*The nuts and spacers were put onto the axle of the motor before packing, please rearrange the order or adjust the number of the spacers if necessary. (Note: Don't remove the lock washers and the spring washers)

5. Installation Steps

Add the washers and nuts to the axle as shown below.

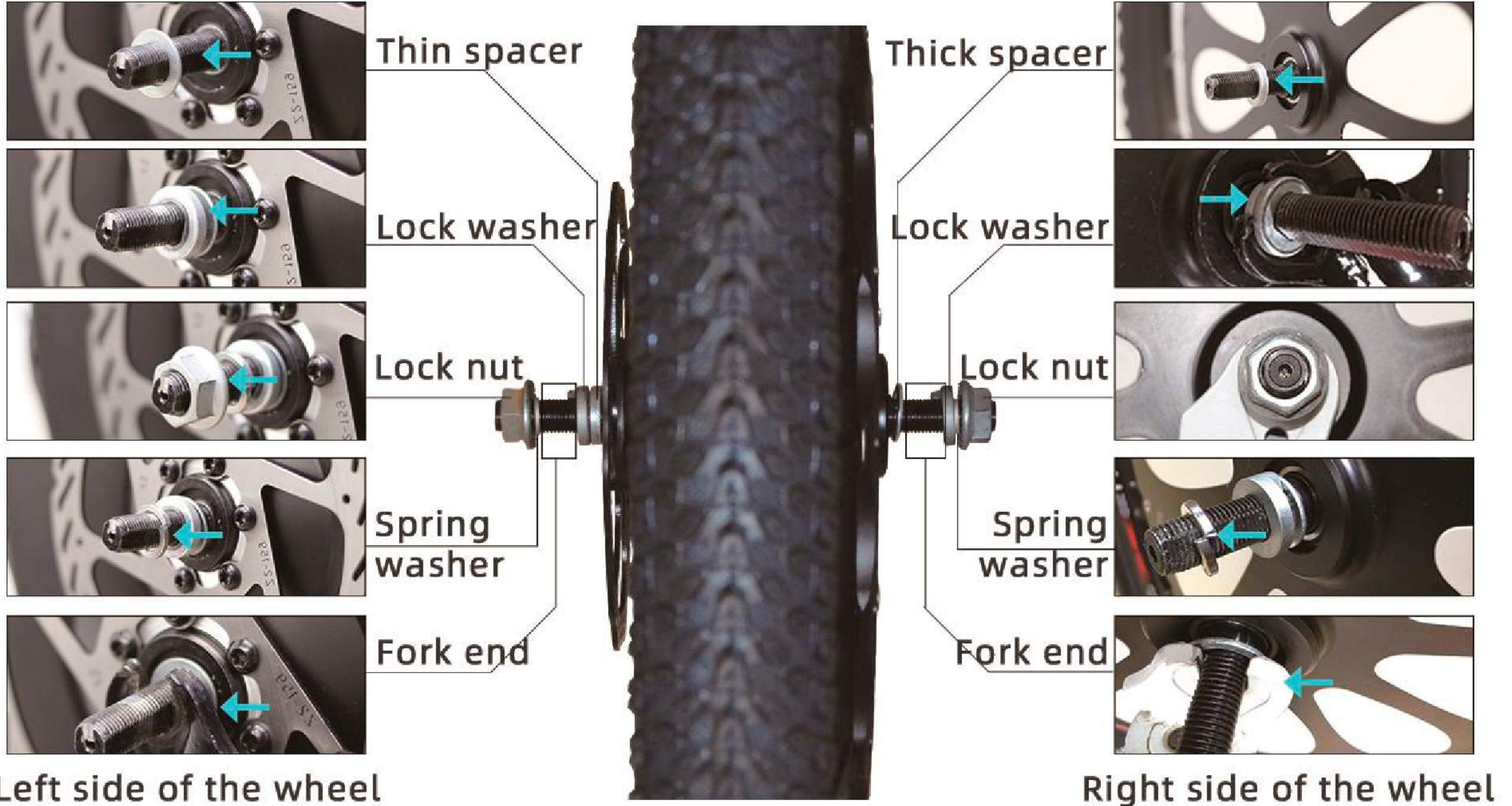

*Please rearrange the order or adjust the number of the spacers if necessary.

5. Installation Steps (Continued)

Adjust the disc brake

Reason of disc collision

1. Disc deformation
2. Calliper tilt

Disc deformation correction adjustment:



Note: If you have problems during the process of adjust the disc brake, please ask a bike shop for help.

Use a monkey wrench to clamp the disk and correct the deformation.

5. Installation Steps (Continued)

Adjust the disc brake

Loosen this bolt to adjust the space of the brake linings



Loosen these 2 bolts to adjust the position of the calliper

5. Installation Steps (Continued)

Tighten the lock nuts

Tighten the two nuts on both sides of the wheel.



If there is a groove on the fork end, use a spring washer to make it flat to avoid the tightened nut pressing on and eventually breaking the fork end.

There must be a spring washer between the fork end and the lock nut to avoid breaking the fork end by tightening the lock nut.



5. Installation Steps (Continued)

Put the axis into the slots of the front fork ends, make sure the notch on the axis points to the handlebar



The notch points to the handlebar



6. Charge Instruction

when it is charging the indicator light is red and the light is green when it is charged fully.

connect 110V-240V AC
AC plug



connect to charge port of the wheel **DC connector**

! Notice: connect the DC connector to the charge port of the wheel before connecting the AC plug to the AC

Tbike

 **TBIKE.CL**

 **TBIKE_CL**